



# IELTS Mock Test 2022 June

## Writing Practice Test 1

### HOW TO USE

You have 2 ways to access the test

1. Open this URL <https://link.intergreat.com/wX3rg> on your computer
2. Use your mobile device to scan the QR code attached



# WRITING TASK 1

You should spend about **20** minutes on this task.

The diagrams below show the existing ground floor plan of a house and a proposed plan for some building work.

Summarise the information by selecting and reporting the main features and make comparisons where relevant.

You should write at least **150** words.

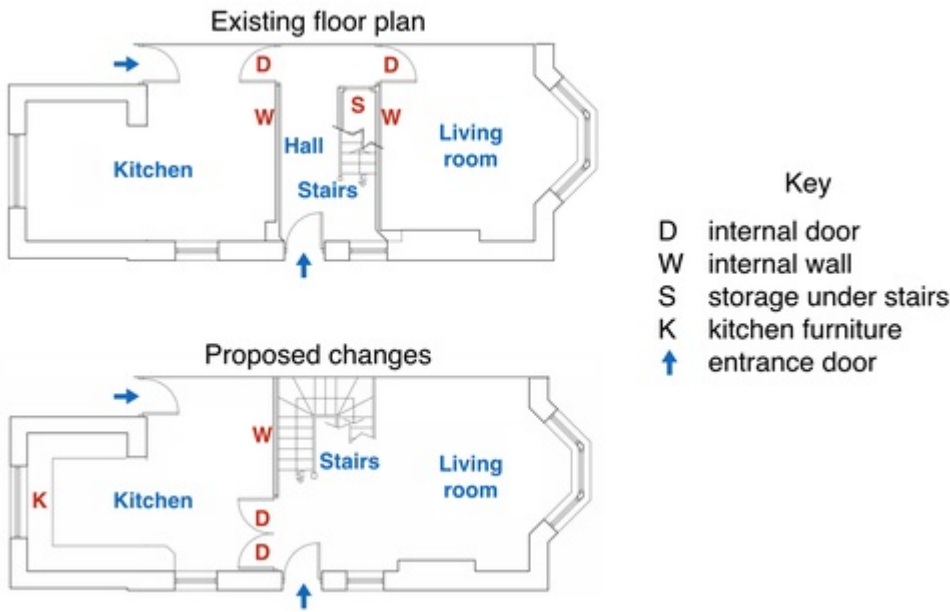

# WRITING TASK 2

You should spend about **40** minutes on this task.

Write about the following topic.

*Some people believe that teaching children at home is best for a child's development while others think that it is important for children to go to school.*

*Discuss the advantages of both methods and give your own opinion.*

Give reasons for your answer and include any relevant examples from your own knowledge or experience.

You should write at least **250** words.

# SAMPLE WRITING TASK 1

The diagrams illustrate some changes made from an existing building plan for a house.

It is clear that there are some major alterations, in particular in the middle of the ground floor. Living room and kitchen areas remain unchanged.

The existing ground floor plan shows the kitchen can be accessed through an entrance door on the left of the ground level. The kitchen on the left and the hall in the middle are separated by an internal wall as well as a door. A stair case is situated to the right side of the middle compartment, with a small storage underneath. Living room is planned on the right of the ground floor. A symmetric internal wall and door are used to divide between the living room and the middle part of the house. An entrance door makes stairs and the hall accessible from outside.

The proposed plan is to integrate the middle and the right parts of the house together. Therefore, the ground floor is simply segregated into left and right compartments by one internal wall and a double door. The entry hall will disappear and be replaced by the extended L-shaped stairs. Although the area of the kitchen remains the same, some kitchen furniture is going to be constructed on the left side of it.

# SAMPLE WRITING TASK 2

One school of thought is that the best approach for child's development is that if parents teach their children themselves at home. On the other hand, the second school of thought is that children should attend school for their better development. There is no general consensus over this and both approaches have advantages.

Let's see the advantages of the first approach. It is understood that no one can better understand their child except his/her parents. A child is with the parents since birth and parents know each and every aspect of the child. While teacher has to teach the whole class and take every student along with including slow learners and fast learners. Whereas parents have one child to teach and they can give him/her their hundred percent attentions. They can schedule the teaching as per their child's pace. Moreover, parents can better look after the child.

Another approach is attending school. This method has its own advantages. In school, a child has to spend his time in the class with other children of the same age. He/she starts making new friends. They not only talk about studies but also discuss other happenings around them. They share knowledge and information with each other. All the children take part in group activities including extracurricular activities. As a result, their confidence increases many folds.

As we have seen, both methods have their own advantages. However, I strongly feel that it is very vital for children to attend school. This way, school and parents share the responsibility of development of the child and it is the best approach.