



IELTS General Training Volume 5 Listening Practice Test 1

HOW TO USE

You have 2 ways to access the listening audio

1. Open this URL <https://link.intergreat.com/2ACbi> on your computer
2. Use your mobile device to scan the QR code attached



Questions 1-5

Complete the following information using **NO MORE THAN THREE WORDS OR NUMBERS**

Surname	1 _____
Given name	Sharon
Address	2 _____ . Tipton. TP3 4MB
Date of birth	3 _____
Type of membership	annual
Amount due	4 _____ £
Credit card number	4673 9702 0361
Expiry date	5 _____

Questions 6-9

Label the diagram of the gym using **FOUR** of the following six labels. Write the appropriate letter in the correct space on your answer sheet.

A	free weights area
B	ladies' changing area
C	men's changing area
D	refreshment area
E	treadmills
F	various machines

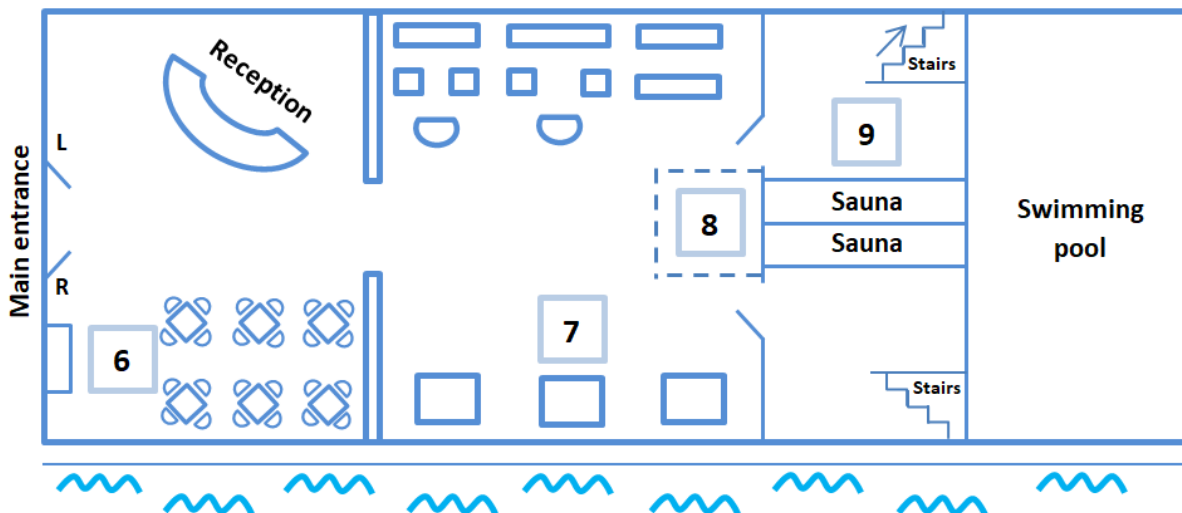

- 6
- 7
- 8
- 9

Question 10

10 Decide which pair of pie charts illustrate the membership of the gym and spa and write the appropriate letter on your answer sheet.

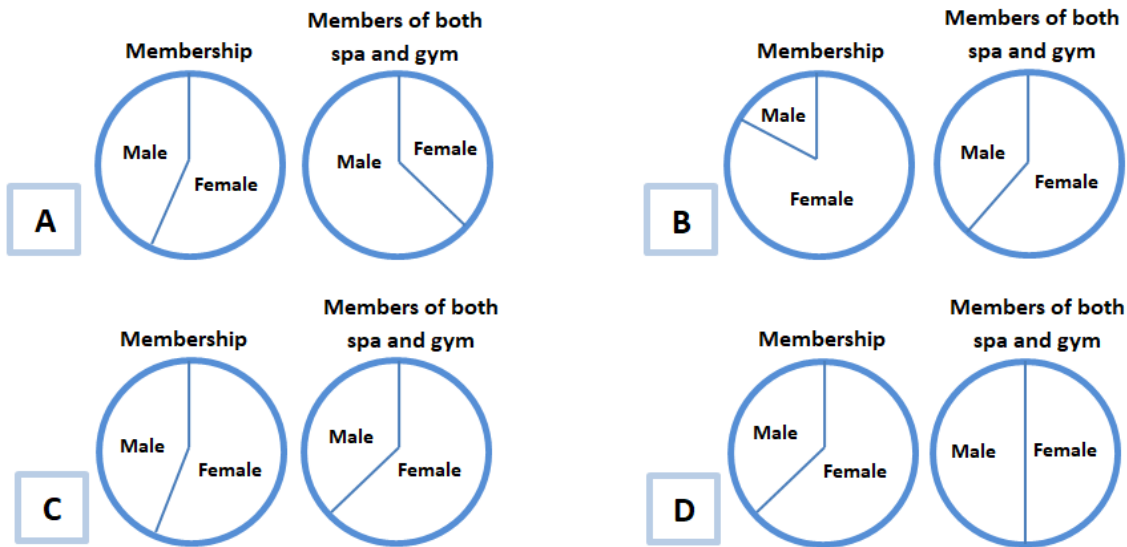

- A
- B
- C
- D

Questions 11-12

Complete the following sentences using **NO MORE THAN TWO WORDS** for each answer.

The university has produced a 11 _____ to inform students about the different accommodation options available.

All catered and self-catered accommodation is close to the 12 _____

Questions 13-16

On your answer sheet, write

A	if the statement applies to catered accommodation
B	if the statement applies to self-catered accommodation
C	if the statement applies to private accommodation
D	if the statement is not mentioned at all by the accommodation officer

13 Meals are included in the rent.

14 This is the best accommodation for people who want to choose when they eat.

15 Most students live in this kind of accommodation.

16 This is the most expensive type of accommodation.

Questions 17-20

Decide which letter on the map shows the location of each of the following university halls of residence.

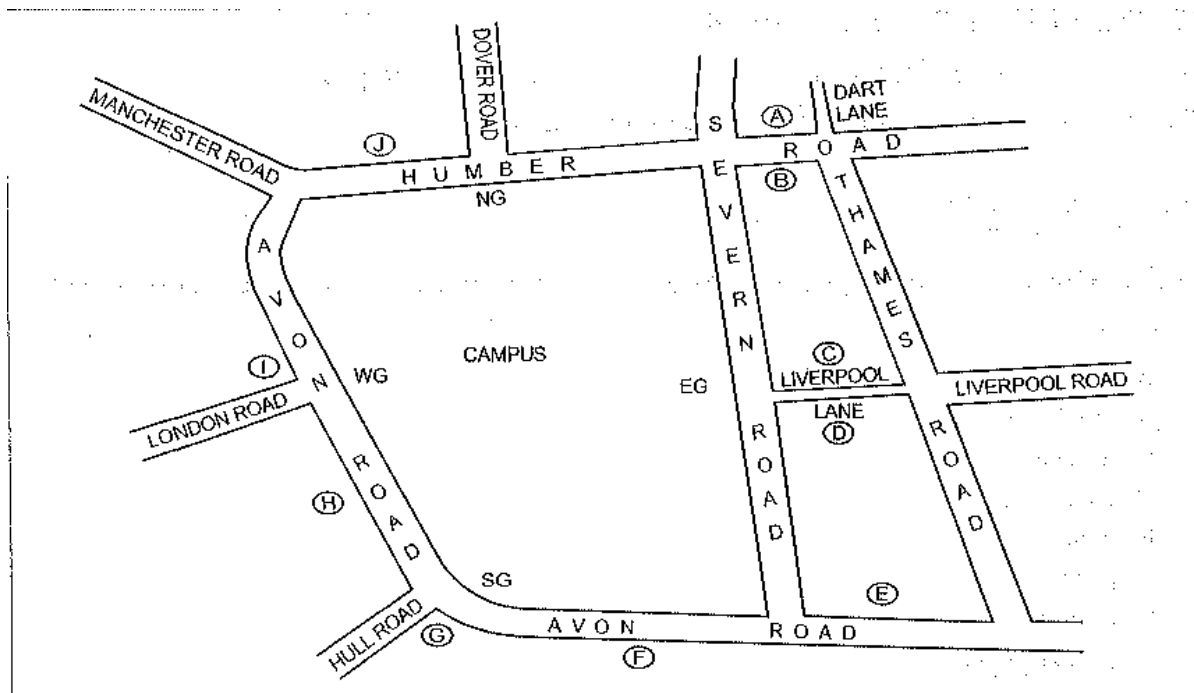

17 Malvern Halls

18 Grampian Halls

19 Brecon Halls

20 Sperrin Halls

Question 21-24

Answer the questions using **NO MORE THAN THREE WORDS** for each answer.

When did Jenny arrive at the university? Last 21

What is Tom going to study? 22

What is Jenny going to study? 23

What two items have the students been given? 24

Question 25-27

Complete the following sentences using **NO MORE THAN TWO WORDS AND/OR NUMBERS** for each gap.

Tom's Halls of Residence is named 25

Tom's accommodation is a 26 from the campus.

Jenny's accommodation is near the campus, close to the 27

Question 28-30

Decide which **THREE** items Jenny needs to buy and write the appropriate letters on your answer sheet **in any order**.

- A binders
- B notebooks
- C notepaper
- D paperclips
- E pencils
- F pens
- G primer

Questions 31-33

Choose the correct letter, A, B, C or D.

Write your answers in boxes 31-33 on your answer sheet

31 Which pie chart shows the ages of the Asian students surveyed ?

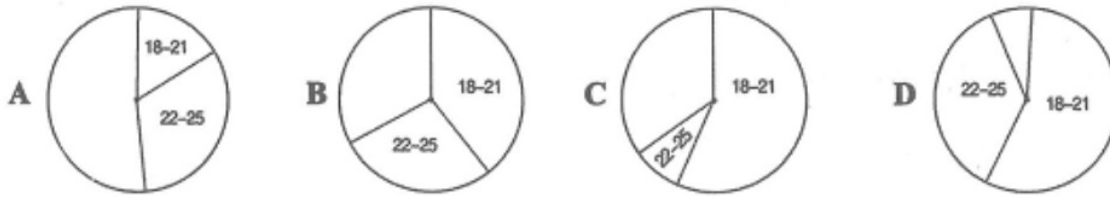

- A
- B
- C
- D

32 Which pie chart shows the main reasons Asian students wanted to study abroad?

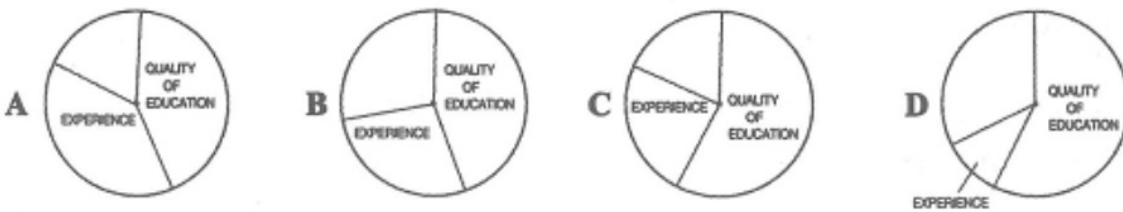

- A
- B
- C
- D

33 Which bar chart shows the percentage of Asian students who made Australia their first choice destination?

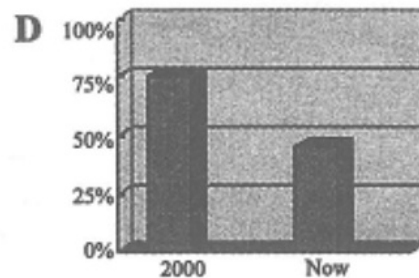
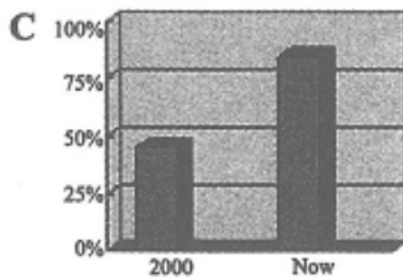
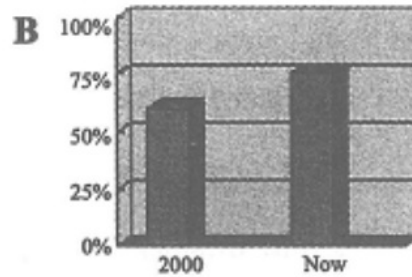
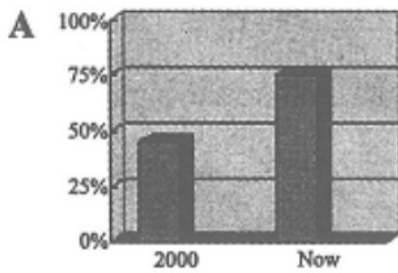

- A
- B
- C
- D

Questions 34-35

Answer the following questions using **A NUMBER** for each answer.

Approximately how many foreign students enrolled in Australia in the year 2000?

34 _____

How much did Australia's education exports rise by last year? 35 _____

Questions 36-40

Complete the following sentences using **NO MORE THAN TWO WORDS/NUMBERS** for each gap.

It became harder to get a 36 _____ for the USA after September 11.

37 _____ of Asian students gave lower study fees as a reason for choosing Australia.

Asian students rank Australia number 38 _____ in terms of educational quality.

39 _____ programmers are unlikely to reduce the number of students going abroad in the near future.

Asian students are increasingly using 40 _____ to help arrange their studies abroad.



Solution:

Part 1: Question 1 - 10

- | | | | |
|---|----------------|----|-----------------|
| 1 | Pierce | 2 | 70 Welcome Lane |
| 3 | 13th July 1980 | 4 | 180 |
| 5 | September 2009 | 6 | D |
| 7 | E | 8 | A |
| 9 | B | 10 | C |

Part 2: Question 11 - 20

- | | | | |
|----|-------|----|-------------|
| 11 | guide | 12 | city center |
| 13 | A | 14 | B |
| 15 | D | 16 | D |
| 17 | B | 18 | D |
| 19 | H | 20 | F |

Part 3: Question 21 - 28

- | | | | |
|----|-----------|----|------------------------------|
| 21 | Thursday | 22 | European History |
| 23 | Geography | 24 | timetable, reading/book list |

25 Wish Lane

27 north gate

Part 4: Question 31 - 40

31 D

33 A

35 17.8%

37 20%

39 Trans-national (education)

26 30 minute walk

$\frac{28}{30}$ A,B,H

32 B

34 100000

36 visa

38 three/3

40 education agents



Audio Script:

Woman: Hello. I'd like to become a member of the gym .

Man: Certainly. Have you filled out an application form?

Woman: Not yet. Do you have one?

Man: Yes. I've got one right here. Or I could just enter your details directly into the computer. It would be quicker.

Woman: OK. Go ahead.

Man: Could you tell me your name, please?

Woman: **Q1** My surname is Pierce-P I E R C E-and my given name is Sharon- S H A R O N.

Man: Thank you. **Q2** And your address?

Q2 Woman: 70 welcome lane . Tipton, TP3 4MB.

Man: **Q3** Could I just note your date of birth?

Woman: **Q3** 13th of july 1980 .

Man: Are you just applying for membership of the gym or would you like to join the health bar as well? There's a special price of £50 a month or a hundred and thirty pounds for three months.

Woman: I'd just like to join the gym, thanks.

Man: OK. That's £20 a month, £50 every three months or **Q4** 180 pounds a year.

Woman: I'll pay for the year.

Man: Will you be paying by credit card ?

Woman: Yes. Here you are.

Man: Thank you. Card number four six seven three nine seven oh two zero three six one expiry

Q5 dates September 2009 okay. OK. I'll just print out a form for you to sign and you're a member. ... There you are. Sign here, please.

Woman: Great. Thank you. Could you just show me around very quickly?

Man: Certainly. Mike? Could you take over here for a few minutes? ... Come this way. **Q6** Right by reception , we have a refreshment area, serving healthy food and drinks-no coffee or chocolate!

Woman: What a good idea!

Man: Beyond that, as you can see, there's the main gym area. **Q7** The treadmills are by the window, so you get a great view across the river. **Q8** Opposite them are various machines and at the far end you can see the free weights area. If you look at the far end, you'll see two doors. **Q9** The one on the left is the ladies' changing area and the one on the right is the men's.

Woman: And the swimming pool?

Man: There's a door in each changing area that leads to the swimming pool .

Woman: The health spa is upstairs isn't it?

Man: Yes, there's a flight of stairs leading from each changing room to the spa area. Oh, I forgot to mention that there's a sauna beside each changing area. Our members love using those after a workout.

Woman: How many members are there?

Man: **Q10** About 300 people, of which 200 are members of both the gym and health spa. Only about half of those people come regularly.

Woman: Does it ever get crowded ?

Man: It can get a little cramped at the weekends and occasionally in the evenings during the week. A lot of people like to use the treadmills . There are no rules about how long you can use a particular machine, but we ask people to be considerate . The swimming pool rarely gets crowded.

Woman: Are most of the members men or women?

Man: **Q10** I'd say that there are a few more women than men. Ladies are more likely to join the gym and spa, whilst men usually just join the gym.

Woman: Well, thank you very much. I'll be along tomorrow for my first workout you're . You open at 7, right?

Man: Yes, we're open from 7 in the morning to 10 in the evening. See you tomorrow!

Accommodation officer: We understand the importance accommodation plays in student life. Which is why we aim to provide you with not only the best possible range and standard of housing, but also advice and assistance on the whole accommodation process . With our help you should find yourself somewhere you want to live and get settled in with as little hassle as possible. **Q11** Throughout the guide that I have just handed , you will find details of the wide range of accommodation available at the university and how you can apply for it.

We hope that the information we provide will assist you to make your choices, but please contact us at any time if you have any questions. **Q12** Our accommodation ranges from the catered to the self-catered, the modern to the traditional , and is based over 25 sites across the city, all of which are located within a short walk or bus ride of the city centre.

First, let's look at catered accommodation. Moving away from home for the first time can be as scary as it is exciting. **Q13** Our traditional catered accommodation makes things easier for you, with meals included in the rent and a comprehensive support network to help you adjust. And with around 2,000 students in catered accommodation you'll have ample opportunity to make new friends.

Q14 If you like choosing what and when to eat, self catering will be ideal. More than half of our new students live in self-catered accommodation, which offers a taste of real independence plus the benefits of a sociable and supportive environment. You can choose from either self-catering flats, larger occupancy residences or university managed accommodation for one person flats, couples or families.

Then there's private accommodation. University accommodation isn't for everyone. **Q15** If for some reason you don't get a place or would prefer to rent privately , we also have a register of **Q16** University approved accommodation and can offer advice and support if you want to rent private flats or lodgings in the city.

Now, here you can see a map of the university accommodation nearest to the campus marvin .

Q17 Malvern Halls are located on Humber Road, between Severn Road and Thames Road. This is the tallest Halls of Residence, being a 25-story block of student flats. You can get a

good view of the campus from here. **Q18** Grampian Halls are also located between Severn Road and Thames Road, where Liverpool Road, sorry Lane, joins the two. Don't get Liverpool Road confused with Liverpool Lane as I just did! It's on the south side of the street.

Q19 Brecon Halls are between the South Gate and the West Gate. They're very slightly nearer the West Gate, actually. These Halls are popular because they are newer and the rooms are somewhat larger than in older Halls. **Q20** Sperrin Halls are nearest to the North Gate ... er ... South Gate, on Avon Road, but not opposite it.

Well, whichever type of accommodation you go for, I hope it suits you. Now, I'd like to mention...

Jenny: Hi Tom! How are you? Have you been here long?

Tom: Hi Jenny! I'm fine. I arrived yesterday, on Sunday. How about you?

Jenny: I got here last week, on wednesday . No, sorry-just a minute, what day is it today? **Q21** Thursday, not Wednesday.

Tom: Why did you come so early? We don't have to be here until tomorrow. Couldn't wait to be free from your parents, I bet.

Jenny: Very funny! I know I came a bit earlier than most people, but I wanted to move my things into my flat and take a look around the campus and the town. So, did you decide to take English literature in the end?

Tom: No, I changed my mind and decided on **Q22** european History instead. At school, you said you were going to take **Q23** geography , right?

Jenny: Yes, although I was also considering geology.

Tom: Sounds the same to me!

Jenny: Well, I guess there are similarities , but they're not quite the same. What kind of information have you been given about your courses?

Tom: Well, not much. **Q24** I've got my timetable and a basic reading list.

Jenny: Yeah, me too. I've been given a list of books to start reading. I think there are 5 or 6 of them.

Tom: Yeah, I've got a similar list. They're just books that provide the basics for the courses during the first year.

Jenny: So, what's your timetable like? I get Wednesday and Friday afternoons off, but the rest of the days are fairly full.

Tom: Me too. Do your lectures and seminars start next week too?

Jenny: Yes. I think everyone's do. This week is just orientation, isn't it?

Tom: That's what I gathered. My first class on Monday morning is wait for it oh, Modern British History-I'm looking forward to that! How about you?

Jenny: Erm ... Human Geography-also on Monday morning.

Tom: It says here that the title of the first lecture is "The Victorian Legacy" – sounds good! How about you?

Jenny: I've got "Global Population distribution ". Intriguing! ... Where are you living?

Tom: I got a place in the Halls of Residence at **Q25** Wish Lane Hall.

Jenny: Wish? As in 'make a wish'.

Tom: Funny name, eh?

Q26 Jenny: I'm at Bridge Road Halls of residence .

Q26 Tom: That's very close to the university campus, isn't it? My place is

Q26 a bit further away.

Q26 Jenny: Can you walk or do you need to take a bus?

Q26 Tom: Erm ... I can walk, but it takes about 30 minutes . There's a bus.

I guess I'll walk if it's not a bad day and take the bus if it's raining.

Jenny: I'll think of you when I am taking the five minute walk from my hall to the lecture !

Tom: I'm sure you will! At least I've got somewhere to stay if I don't want to walk home!

Jenny: Cheeky!

Q27 Tom: Is your hall near the main gate or the north gate?

Q27 Jenny: The north gate. Hey, I'm on my way to the shops. Coming?

Tom: Sure. What are you going to buy? Food?

Jenny: Well, I might pick up a few things, **Q28** but I was really going to buy some notebooks for taking lecture notes seminar notes **Q29** and some printer paper.

Tom: That's a good idea. **Q30** I need a few binders to put my notes in.

Jenny: That's a good idea. I'll get a couple too. Pencils? No, I've got a few.

Tom: Oh, some pens-I always seem to lose them! Well, you've been here the longest. Where do we go?

Jenny: There's a shop here on campus, near the main gate. There's a café next door, so we can stop there too, if you like.

Tom: Great idea – I could do with a coffee and a cake!

Presenter: Welcome to this presentation on the results of our survey of Asian students in Australia, the UK and the US. Australia is growing in popularity among Asian students, while the UK and the US are losing ground as the place to study for a degree, according to our international survey. **Q31** Our research is based on the views of 1500 undergraduates from 10 Asian countries studying in Britain, the USA and Australia. 60 percent of the students were aged between 18 and 21. and 30% were between 22 and 25. **Q32** Four in 10 students cited a better quality of education as their main reason for studying away from their home country. About 27 percent said they were doing it to broaden their experience and because they were attracted by the cultural experience of living in a foreign country. Business, commerce and marketing are still by far the most dominant field of study, attracting almost two-fifths of students. **Q33** Three quarters of Asian students polled in Australia said it was their first choice, compared to less than half when we conducted the same survey in the year 2000. From an Australian perspective, it's very positive because more and more students are consciously choosing Australia rather than it being a second choice. The UK and American parts of the

survey show that they are no longer the preferred destinations they were, despite still being seen as offering the best education in the world. Australian universities have done a really good job of promoting Australia as well as their own universities. Australia is seen as good value for money and is attracting the more price- sensitive students.

Q34 Australia's overseas student enrollments have doubled since the year 2000 to 200000 in 2006 at a time when they have declined in the US and the UK's share of the global market is declining. **Q35** Reflecting this increase, Australia's education exports rose 17.8% last year and were valued at more than five billion dollars for the first nine months of 2006. **Q36** In the United States, a clamp down on foreign students following the terrorist attacks on September 11 has made many Asian students feel unwelcome. As a result, applications to American universities have declined. This could happen in the UK. If students find it hard to get visas they could question whether the country really wanted them. Another factor in Australia's growing popularity was the wish of some members of the growing Asian middle class to settle in the country after studying there.

The cost of study and value for money also featured highly on the list of reasons students gave for choosing Australia as a study destination : much higher than in Britain. 34% said **Q37** they selected Australia because they thought living expenses were relatively less expensive and 20 percent made their decision because tuition fees were cheaper. Quality remained the biggest draw-card for students wanting to study in Australia, reinforcing the critical importance of its reputation overseas, according to new research. **Q38** Asian students still ranked the US and Britain as having the highest quality universities but Australia rated third, but ahead of other destinations like Canada, New Zealand and Germany. **Q39** Despite the emergence of trans-national education programmes. eighty-one percent of students did not consider undertaking a foreign degree in their home country. It seems that the concern that these programmes are going to diminish the number of foreign students is a bit premature .

Only 4% of those enroll in Australia had studied overseas before, a figure we attribute to an emerging middle class of Asian students wanting to study offshore . In the past, many Asian students had come from their home country's elite, high income families whose parents had studied abroad. What we've got now is an emerging middle class who maybe haven't travelled before and whose parents were not educated overseas. **Q40** Our study also shows that students rely more on education agents than in the past with implications for universities that plug direct enrolments online. Whilst our findings are good for Australia, which is increasing in popularity as a study destination , they do not mean that Australia can rest on its laurels as competition is increasing from a growing number of institutions and study destinations.