



Succeed in IELTS Volume 10

Listening Practice Test 1

HOW TO USE

You have 2 ways to access the listening audio

1. Open this URL <https://link.intergreat.com/gC6XD> on your computer
2. Use your mobile device to scan the QR code attached



Questions 1-6

Complete the notes below with **NO MORE THAN TWO WORDS AND/OR A NUMBER**

Student Hostel

CHARGES FOR MEALS	
Breakfast	\$2.00
Lunch	\$ 1 <input type="text"/>
Dinner	\$3.00
2 <input type="text"/>	\$48.00 per week
Two-Meal Plan	\$ 3 <input type="text"/> per week
Students who buy meal plans must bring 4 <input type="text"/> to the cafeteria	
MEAL TIMES	
Breakfast	5 <input type="text"/>
Lunch	12:00 p.m to 2:00 p.m
Dinner	6 <input type="text"/>

Questions 7-10

Label the plan below.

Write the appropriate letter, A-F, next to questions 7-10.

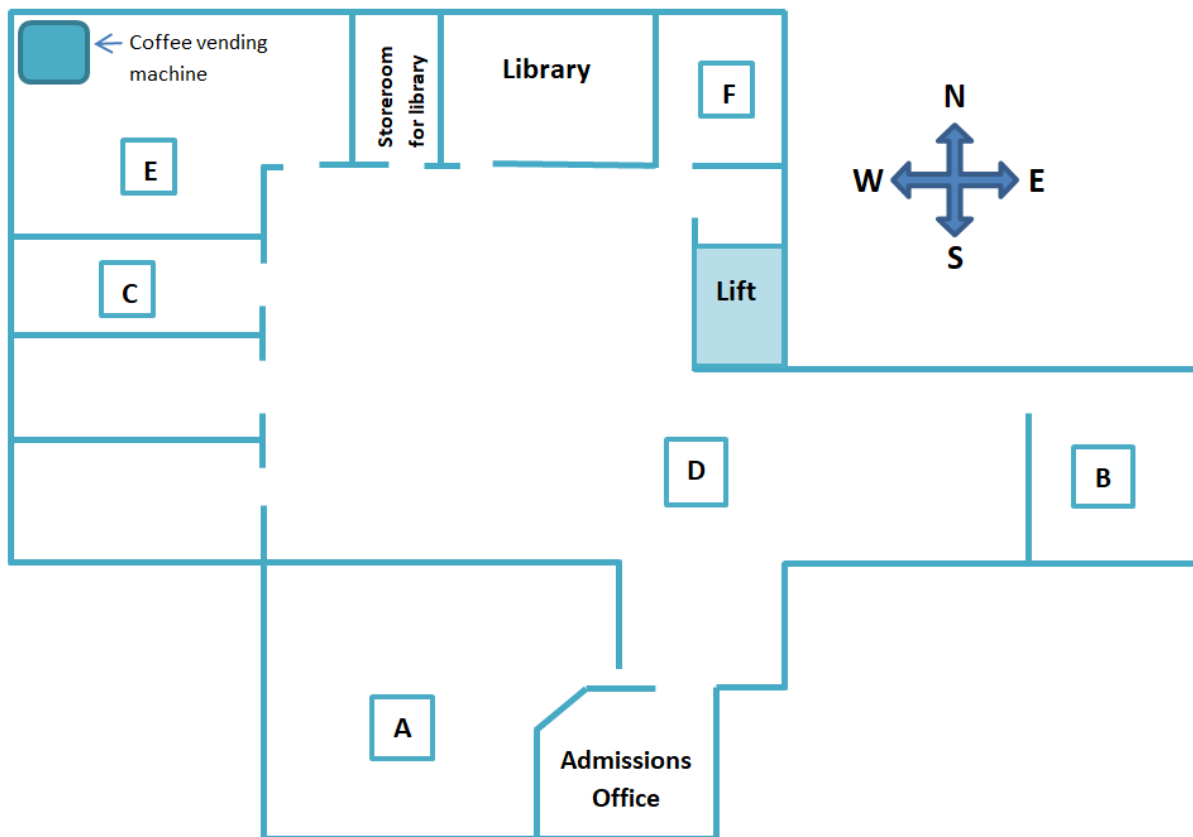

- 7 Fees Office
- 8 Student Lounge
- 9 Key Room
- 10 Box Room

Questions 11-17

Complete the notes below.

Write **NO MORE THAN THREE WORDS AND/OR A NUMBER** for each answer.

SCHOOL EXCURSION PERMISSION NOTE

Class	11 <input type="text"/>
Excursion to	12 <input type="text"/>
Day and date	13 <input type="text"/>

Departure from	14 _____ at 8:00 am
Return via	15 _____ at 6:00 pm
Tasks	On arrival
Food	Fruit and fruit juice provided on bus. Students must bring 16 _____
Sightseeing	Rough country
Clothing	Need to have 17 _____
Signature of Guardian/ Group Leader	

Questions 18-20

Complete the sentences below.

Write **NO MORE THAN THREE WORDS** for each answer.

The first activity will be completed 18 _____

There is a 19 _____ on the bus in the event of an emergency.

The previous excursion with class 3B was 20 _____

Questions 21-25

Complete the table below.

Write **NO MORE THAN TWO WORDS AND/OR A NUMBER** for each answer.

Hospital wards	Intensive Care	Maternity	23 _____	Emergency
Visiting hours	6:00am - 12:00am	22 _____	9:00am -9:00pm	25 _____
Comments	21 _____	very tired	on heavy 24 _____	comfort patient

Questions 26-27

Complete the sentences below.

Write **NO MORE THAN ONE WORD AND/OR A NUMBER** for each answer.

Children are discouraged from visiting in intensive care because it may 26 _____ the patient.

The maximum number of people who can visit mothers of newborn babies is 27 _____.

Question 28

Choose **TWO** letters, A-F.

Which **TWO** doctors will Andrew observe on Tuesday?

- A** ☐ Dr Thompson
- B** ☐ Dr Kim
- C** ☐ Dr Thomas
- D** ☐ Dr Robertson
- E** ☐ Dr Roberts
- F** ☐ Dr Shay

Questions 29-30

Write **NO MORE THAN THREE WORDS AND/OR A NUMBER** for each answer.

Where will the lectures be held?

29 _____

What proportion of nursing students is male?

30 _____

Questions 31-37

Complete the summary below.

Write **NO MORE THAN TWO WORDS AND/OR A NUMBER** for each answer.

Samuel Wells had a vision of a college in which 31 _____ would be encouraged between people of different races and nationalities.

Of Scholastic House's ten original students, 32 _____ proceeded to lead illustrious lives. The

most prominent became a 33 _____, while another two became engineers who went on to 34 _____ the manner in which water systems were managed.

Scholastic House experienced difficulties during the Great War. The charter of the college did not allow

its students or staff to participate in the war, and many people interpreted this as a lack of 35 _____

The college, however, did go on to build a reputation for learning and 36 _____ of different views.

Since 1927 it has been discussing and debating topics over the years which were seen as 37 _____ at the time.

Questions 38-40

Choose the appropriate letter, A, B, C or D.

38 Controversial issues are discussed by the college because it wants

- ☐ A to shed light on the topics and encourage debate.
- ☐ B to decrease tension in the discussion.
- ☐ C to encourage argumentation.
- ☐ D to bring about positive publicity.

39 The speaker believes that

- ☐ A science is less advanced than medicine.
- ☐ B philosophy is more useful than science.
- ☐ C science receives more attention than philosophy.
- ☐ D science is more useful than philosophy.

40 Students are urged to

- A** ☐ accept what they are told.
- B** ☐ ask questions at all times.
- C** ☐ think only about their studies.
- D** ☐ think where progress will lead them.



Solution:

Part 1: Question 1 - 10

- | | |
|-------------------------------|-------------------------------|
| 1 3.00 | 2 3/three-meal plan |
| 3 36.00 | 4 vouchers |
| 5 7:00 to 9:00 a.m/7 to 9 a.m | 6 6:00 to 8:00 p.m/6 to 8 p.m |
| 7 B | 8 E |
| 9 F | 10 C |

Part 2: Question 11 - 20

- | | |
|--------------------|----------------------------|
| 11 3A | 12 (the) Blue Mountains |
| 13 Monday, June 10 | 14 front gate |
| 15 side gate | 16 lunch |
| 17 strong shoes | 18 before lunch |
| 19 first aid kit | 20 (thoroughly) successful |

Part 3: Question 21 - 30

- | | |
|---------------------|----------------------|
| 21 very sick | 22 8:00 am - 8:00 pm |
| 23 Surgical (wards) | 24 painkillers |

25 24 hours/all day

27 six

29 Redmore Lecture Room

Part 4: Question 31 - 40

31 friendship

33 (university) teacher

35 national spirit

37 controversial

39 C

26 distress

28 C,D

30 one third/1/3

32 nine

34 (deeply) influence

36 tolerance

38 A

40 D

Section 1

Student: Excuse me. I want to ask you about the charges for meals. Are they the same as they were last year?

Manager: No, I'm afraid they're not. We've managed to keep most of them the same, but we've had to increase the charges for breakfast.

Student: How much is it now?

Manager: It's \$2.50. It used to be \$2.00.

Student: I see. What about lunch?

Manager: **Q1** It's unchanged—still \$3.00.

Student: **Q2** Does dinner still cost \$3.00?

Manager: **Q2** Yes, it does. But we've managed to keep the prices down this year. But the best deal is the **Q2** three-meal plan for \$48.00 per week. We give you vouchers to present when you come into the cafeteria, and you get 21 meals for your \$48.00. That works out to a little more than \$2.00 a meal. The two-meal plan has gone up from last year's rate to **Q3** \$36.00 per week. We give you **Q4** vouchers for that, too.

Student: My sister was in this hostel before me. I'm sure the hours for breakfast used to be longer.

Manager: Yes, they were. They used to be 7:00 to 9:30, but to keep our expenses down we made them **Q5** 7:00 to 9:00 am.

Student: Lunch is the way it was, though. Hold on! Dinner 6:00 to 7:30? Isn't that a change?

Manager: Yes, it is, and in fact the form is wrong. It used to be 5:30 to 7:30, but now it's **Q6** 6:00 to 8:00 pm.

Student: 6:00 to 8:00 pm. That's good.

Manager: So which meal plan would you like?

Student: I'd like to think about it, please. I need to check my lecture schedule. I'll let you know by Friday.

Student: Can you tell me how to get to my room, please?

Manager: Of course. You're in the new wing. But I'm afraid you're going to have to go to a couple of other offices before you can have the key. **Q7** You're in the Admissions Office now. Leave this office and turn right and go to the end of the hall. The last office is the fees office,

where you can pay the balance of your room deposit. They'll give you a receipt.

Student: Okay.

Manager: After you've been to the fees office come back past Admissions. **Q8** You'll see a very large room at the north-western corner of the building. You can't miss it. That's the student lounge, and if you go in there you can meet some of the other students and see who'll have a room near you.

Student: That's good. Can I get a cup of coffee there?

Manager: Yes, there's a vending machine in the corner. **Q9** Then go to the Key Room, which is opposite the lift and next to the library, show them your receipt, and you can pick up your key there.

Student: My luggage was sent on ahead. Do you know where I should collect it?

Manager: **Q10** The box room is next to the women's toilet. You'll have to get the key from the key room.

Student: Thank you.

Section 2

Mrs Brown: Good morning students. My name is Mrs Brown, and I'm in charge of the school excursion next week. Please take out your School Excursion Permission Note so you can fill it in. For insurance purposes, this note must be signed by your guardian or the group leader. First of all, fill in the name of your class. Everyone here is in 3A, aren't they? So, write **Q11** 3A where it says "class". We're going to the Blue Mountains, which is great, so this is the school excursion to **Q12** the Blue Mountains. The day we leave is Monday, that's **Q13** Monday, June 10.

We are travelling by bus all the way, so we don't have to worry about changing trains or anything like that. The bus will leave from the **Q14** front gate at 8:00 a.m. I know we usually use the side gate, but because of the roadworks we will be using the front gate when we leave. However, when we return the roadwork will be complete so we'll use the **Q15** side gate. We expect to be back at 6:00 pm.

It's going to be a lovely day. Your teachers will give you tasks to do when we arrive. We'll provide fruit and fruit juice on the bus, but you must bring **Q16** your own lunch.

While we're on the excursion we'll be moving around a lot in some fairly rough country. Be very careful to wear **Q17** strong shoes. It's very important that you look after your feet very well. Now does anyone have any questions they want to ask?

Mrs Brown: No questions? Okay. I'd just like to fill in a few more details. The bus should arrive in the Blue Mountains at 11 am. We'll have time to do the first of our tasks **Q18** before lunch.

The bus is not a new one, but it does carry one piece of special equipment—a **Q19** first aid kit. I certainly hope we won't have to use it, but it's nice to know it's there in case we have a medical emergency.

The other class on this excursion is 3B, so I know it'll be a good day. The last time 3A and 3B went out together was a **Q20** thoroughly successful excursion.

Section 3

Mrs Lam: Hello, Andrew. I believe you want to know about visiting hours?

Andrew: Yes, I do Mrs Lam. I have to fill this form out, and I'd like to have some idea why the different parts of the hospital, have different times for visiting.

Mrs Lam: I see. Well, let's start with an obvious one. Intensive care. People in intensive care are **Q21** very sick indeed, and for that reason we say that visitors can come between 6:00am and midnight.

Andrew: I can understand that.

Mrs Lam: At the other end of the scale, our maternity patients are usually quite well, but we restrict their visiting hours from **Q22** 8:00 am to 8:00 pm. We find they get very tired if we permit visitors all the time.

Andrew: I see. What about the **Q23** surgical wards?

Mrs Lam: The doctors prefer to do their rounds early in surgical, so visiting hours are 9:00am to 9:00 pm. Surgical patients are often on very heavy **Q24** painkillers, and they aren't really very good company for their visitors!

Andrew: But surely the visitors come to cheer up the patient, not the other way round?

Mrs Lam: Of course. And often the visitors are able to help the patient a lot. That's why we allow visitors **Q25** all day, the full 24 hours, in the emergency ward. They help comfort the patient while they're waiting to be diagnosed. It's not just everyone who can visit a sick patient. People in intensive care can only be visited by their immediate family. What's more, we only allow two people in at any time. We let children of the immediate family in to visit people in intensive care, but we don't like to do it. It's very hard on the children, and it may **Q26** distress the patient. However, if the patient asks for the child, and the family agrees, that's okay.

Andrew: What about children in maternity?

Mrs Lam: Of course we let them in! They're very pleased to see their mothers. The rule in maternity is everyone may visit, up to **Q27** six people at a time. The maternity ward is quite sociable, after all.

Mrs Lam: Now I have your schedule for the next Week's observation sessions. Are you ready?

Andrew: Yes. Where do I start?

Mrs Lam: On Monday you'll be in male surgical in the morning, and in female surgical in the afternoon. You'll be following Dr Shay on her rounds.

Andrew: Thank you. And on Tuesday?

Mrs Lam: On Tuesday you will be **Q28** with Dr Thomas in the morning and Dr Robertson in the afternoon. No, that can't be right... you're with Dr Thomas in the afternoon and Dr Robertson in the morning.

Andrew: Do I ever get to see Dr Kim?

Mrs Lam: Yes, you'll be with Dr Kim on Thursday and Friday. She'll take you through the children's ward and through our new teenage ward for 12 to 15 year olds.

Andrew: Great! I've read a lot about that new ward. Will I see the school room?

Mrs Lam: Maybe another time.

Andrew: And what will I do on Wednesday?

Mrs Lam: On Wednesday you'll join the other students for lectures. You'll be in the **Q29** Redmore Lecture Room between 8 and 10 am and later between 2 and 3 pm.

Andrew: Thank you. Do you know how big my class is?

Mrs Lam: The intake this term is two hundred first year students. I'm pleased to say about **Q30** one third are men, which is good. Nursing used to be an almost entirely female occupation.

Andrew: I know. My father trained as a nurse, and he was considered very unusual.

Mrs Lam: Is he still working as a nurse?

Andrew: Yes. He's working in a hospital in the country. I guess I just wanted to follow his example.

Section 4

Principal: Good morning, and welcome to Scholastic House. I am delighted to see you here. It is my duty to explain to you some of the history of our college and some of the traditions which I hope you will uphold.

The idea for Scholastic House was expounded by Samuel Wells in 1898. Wells was a visionary whose ideas were well ahead of his time. He wanted a college which would encourage **Q31** friendship between people of different races and nationalities. Wells died in 1900 before he could see the college in action.

[Access https://ieltsionlinetests.com](https://ieltsionlinetests.com) for more practices

Scholastic House finally began operating in 1903 with ten students. Those students came from Asia, Europe, and the Americas. At that time Scholastic House accepted only male students, although it has been co-educational since 1963. Nine of these foundation students went on to lead illustrious lives; the only exception died tragically on his way home from Scholastic House to Sarawak.

He had only recently graduated with an honours degree in Law, and he was robbed of a brilliant future.

The other **Q32 nine** students, as I said, led very fulfilling lives. Three became political leaders, three became doctors. Perhaps the most famous graduate became a **Q33 university teacher** and was responsible for the introduction of modern teaching training methods in his country. Two of the original group became senior engineers and went on to **Q34 deeply influence** the way the water systems of their country were exploited.

The college ran into hard times during the period of the Great War, 1914 to 1918, when the charter of the college was interpreted to mean that neither students nor staff could take part in the war effort. Many people felt that this indicated a lack of **Q35 national spirit**, and the walls of the college were frequently marked with graffiti. Meantime, outside the college, tens of thousands of young men went away to fight in Europe, never to return.

The college was building a reputation for learning and for **Q36 tolerance** of opposing views. Scholastic House debate and discussion nights were opened to the public in 1927, and have been available to anyone who wishes to attend ever since. It is a proud tradition of the college that any view may be expressed provided that it can be defended intellectually. Over the years topics which were **Q37 controversial** at the time have been discussed and debated.

Principal: As I said, the college has a proud history of publicly examining controversial issues. Why should we do this? The publicity we receive is often sensational, and there is no joy in encouraging argument for its own sake; in fact that sort of discussion just increases tension. **Q38 The only legitimate reason for our behaviour is that it casts light upon the topic in question and informs the debate.**

And controversial topics are the ones which most need informed attention. **Q39 As the world forges ahead we often find our scientists have outstripped our philosophers.** We frequently develop scientific marvels without realising their full implications. Nowhere is this more obvious than in medicine. We are now able to keep people alive far longer than before, but this medical ability must be measured in relation to the quality of those lives.

I urge you to spend your time at Scholastic House wisely. You are the heirs of an excellent academic tradition of which we can all be justly proud. **Q40 It is your responsibility to continue this tradition of querying where our world is going. Progress is not always upwards.**

I wish you every joy in your time here, and I hope that I will hear much well informed debate

from you.